

CAM & GROOVE COUPLING

THE QUALITY QUICK COUPLING YOU ARE SEARCHING FOR.

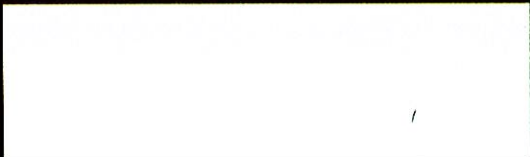

8 basic parts:

Available in size: 1/2", 3/4", 1", 1 1/4", 1 1/2", 2", 2 1/2", 3", 4", 5", 6"

Material of Body: Brass

Aluminum

Stainless Steel (By Investment Cast)

CAM & GROOVE COUPLINGS FOR HOSE & PIPE

(A)



ADAPTOR

Female Thread: NPT, BSP or special thread as demand

(B)



COUPLER

Male Thread: NPT, BSP or special thread as demand

(C)



HOSE SHANK COUPLER

Be attached directly to uncoupled hose with any type clamps or bands

(D)



COUPLER

Female Thread: NPT, BSP or special thread as demand

(E)



HOSE SHANK ADAPTOR

Be attached directly to uncoupled hose with any type clamps or bands

(F)



ADAPTOR

Male Thread: NPT, BSP or special thread as demand

(DC)



DUST CAP

For adaptor type "A, E, F"

(DP)

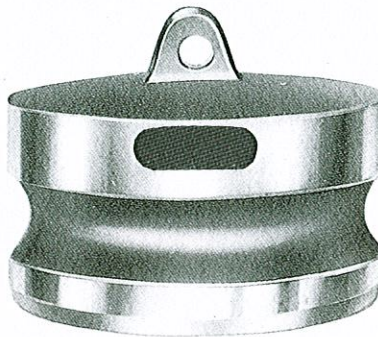

DUST PLUG

For Coupler "B, C, D"

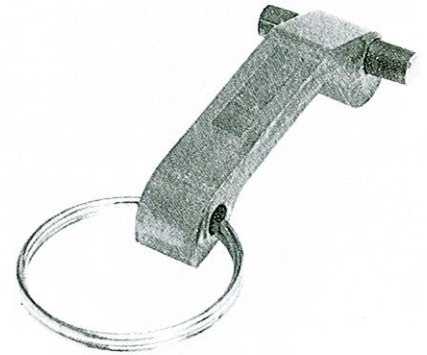

CAM ARM: BRASS, STAINLESS STEEL
PIN: STAINLESS STEEL



GASKET

Buna N: Buna N is standard. It is generally recommended for petroleum derivatives, neutral or slightly acidic salt solutions, alcohols, ethers, glycols, fats, oils, and greases. This compound should give good service from -40°F to +250°F.

Neoprene: Recommended for alkaline and acid salt solutions and aldehydes such as formaldehyde. For food service. White neoprene is also available. Temperature recommended -40°F to +250°F.